

- LEGEND:**
- PLANNING BOUNDARY —
  - CONSTRUCTION COMPOUNDS
  - PROPOSED WWTP/PS
  - PROPOSED ORBITAL SEWER ROUTE (GRAVITY) —
  - PROPOSED ORBITAL SEWER ROUTE (RISING MAIN) —
  - PROPOSED OUTFALL PIPELINE ROUTE (LAND BASED SECTION) —
  - PROPOSED OUTFALL PIPELINE ROUTE (MARINE SECTION) —
  - PROPOSED TRENCHLESS SECTION
  - MANHOLE (MH-1)
  - ACCESS CHAMBER (AC-1)
  - AIR VALVE (AV-1)
  - SCOUR VALVE (SCV-1)

**PROPOSED OUTFALL PIPELINE (LAND BASED)**  
**CHAINAGE: 0+000 TO 3+200**  
**Scale 1:5,000**

**OSI 1:2,500 Sheet No's:**  
 3062-D, 3063-C, 3063-D, 3064-C, 3064-D, 3130-A, 3130-B, 3130-C, 3130-D, 3131-A

**OSI 1:1,000 Sheet No's:**  
 3063-12, 3063-13, 3063-14, 3064-11, 3064-12, 3129-15, 3129-20, 3129-25, 3130-06, 3130-07, 3130-11, 3130-12, 3130-15, 3130-16, 3130-17, 3130-21, 3130-22, 3131-01, 3131-06, 3131-07.

- NOTES:**
- FIGURED DIMENSIONS ONLY TO BE TAKEN FROM THIS DRAWING.
  - ALL DRAWINGS TO BE CHECKED BY THE CONTRACTOR ON SITE.
  - ENGINEER/EMPLOYERS REPRESENTATIVE, AS APPROPRIATE, TO BE INFORMED BY THE CONTRACTOR OF ANY DISCREPANCIES BEFORE ANY WORK COMMENCES.
  - THE CONTRACTOR SHALL UNDERTAKE A THOROUGH CHECK FOR THE ACTUAL LOCATION OF ALL SERVICES/UTILITIES, ABOVE AND BELOW GROUND, BEFORE ANY WORK COMMENCES.
  - ALL LEVELS SHOWN RELATE TO ORDNANCE SURVEY DATUM AT MALIN HEAD.

Rev	Date	Description	By	Chkd.
P01	06.06.18	ISSUE FOR PLANNING	AOC	BD

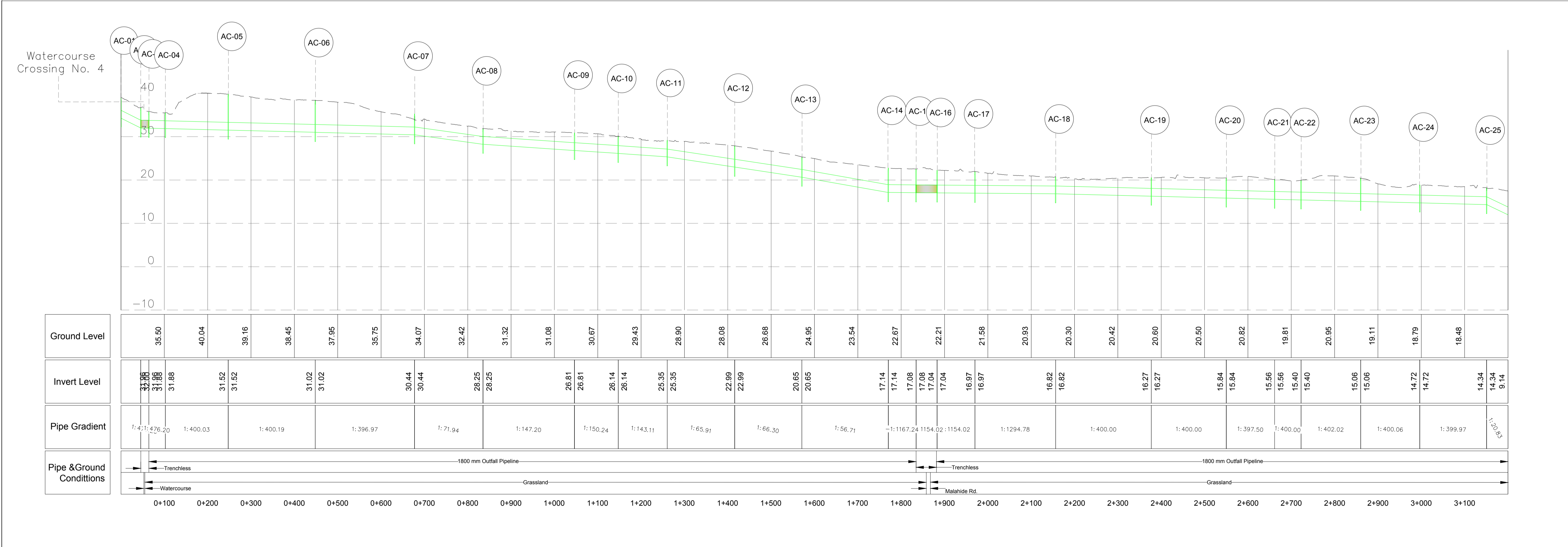

Chainage	0+100	0+200	0+300	0+400	0+500	0+600	0+700	0+800	0+900	1+000	1+100	1+200	1+300	1+400	1+500	1+600	1+700	1+800	1+900	2+000	2+100	2+200	2+300	2+400	2+500	2+600	2+700	2+800	2+900	3+000	3+100
Ground Level	35.50	40.04	39.16	38.45	37.95	35.75	34.07	32.42	31.32	31.08	30.67	29.43	28.90	28.08	26.68	24.95	23.54	22.67	22.21	21.58	20.93	20.30	20.42	20.60	20.50	20.82	19.81	20.95	19.11	18.79	18.48
Invert Level	32.86 31.88 31.88	31.52 31.52	31.02 31.02	30.44 30.44	28.25 28.25	26.81 26.81	26.14 26.14	25.35 25.35	22.99 22.99	20.65 20.65	17.14 17.14	17.08 17.08	17.04 17.04	16.97 16.97	16.82 16.82	16.27 16.27	15.84 15.84	15.56 15.40	15.40 15.40	15.06 15.06	14.72 14.72	14.34 14.34	14.34 9.14								
Pipe Gradient	1:47.26 1:47.26	1:400.03	1:400.19	1:396.97	1:71.94	1:147.20	1:150.24	1:143.11	1:65.91	1:66.30	1:56.71	1:1167.24 1:1154.02 1:1154.02	1:1294.78	1:400.00	1:400.00	1:397.50	1:400.00	1:402.02	1:400.06	1:399.97	1:20.83										
Pipe & Ground Conditions	1800 mm Outfall Pipeline										Trenchless										1800 mm Outfall Pipeline										

**PROPOSED OUTFALL PIPELINE (LAND BASED)**  
**CHAINAGE: 0+000 TO 3+200**  
**Scale H-1:5,000 / V-1:500**

Client: **UISCE**  
 EIREANN - IRISH WATER

Project: **Greater Dublin Drainage**

Title: **PROPOSED OUTFALL PIPELINE ROUTE (LAND BASED SECTION)**  
 - Sheet 1 of 2 -

Scale @ A1: **As Shown**

Prepared by: **A. O'Callaghan** Checked: **B. Downes** Date: **June 2018**

Project Director: **C. O'Keefe**

Drawing Status: **Planning**

**JACOBS** **TOBIN**  
 Patrick J. Tobin & Co. Ltd.

Drawing No.: **32102902-2104P01** Revision: